

KYBO LED

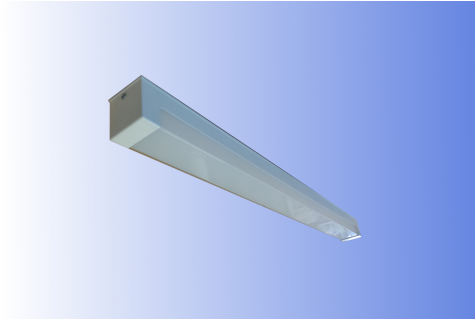

Type of luminaire

KYBO LED is a surface mounted luminaire that can be used in hotels, restaurants etc. For purposes of protection it can be available in IP43. The smart design offers the opportunity for mounting smart sensor with daylight and movement detection. The integrated LEDs are with high-efficiency ensuring good performance with minimum energy. The luminaire is with powder coated steel body.

Key advantages

- low investment cost
- quick pay-off for the initial investments (ROI)
- high energy efficiency
- long life (more than 50,000 h)
- no visible LED dots
- comfort and uniformity of the light output

Mounting type

KYBO LED is a surface mounted luminaire on ceiling and walls.

Application

The luminaire can be used in hotels, restaurants, bathrooms.

Optical system and electrical components

The luminaire is equipped with high-end LED modules and drivers that are supplied by leading companies in the sector such as Philips, Tridonic, Osram, all made in Europe. The LEDs are covered with opal PMMA diffuser to ensure no visible dots and uniformity of the light output.

Electrical connection

The luminaire is equipped with standard 3 poles connector.

Warranty

The operational life of the LED modules used is minimum 50,000 h. The warranty of the luminaire is 5 years.

PRODUCT REVIEW

Technology	LED
Dimmable	No
Type	Integrated LED
Mount	Surface
Control gear type	Electronic
Housing material	Steel
Lumen maintenance L70/B50, L80/B10	>80 000
Photo biological Risk Group	0
Luminaire efficacy (lm/W)	>130
SDCM	3
Fixture Luminous Flux	2500
Glare control	UGR < 19
Color temperature (K)	4000
IP	43
IK	07

GENERAL DATA

Ordering №	1410070520521701020400101
Product name	KYBO
General applications	See above
Sales pack quantity	1
Operating temperature range (°C)	25
Housing color	White RAL 9016

ELECTRICAL DATA

Luminaire Input Power (W)	19
Inrush duration (µs)	126
Inrush current (A)	21
Drive current (mA)	275
Max luminaires per 10A C Breaker	35
Max luminaires per 13A C breaker	50
Max luminaires per 16A C Breaker	60
Max luminaires per 20A C breaker	76
Max luminaires per 10A B breaker	23
Max luminaires per 13A B breaker	30
Max luminaires per 16A B breaker	36
Max luminaires per 20A B breaker	46
CRI	>80
Electrical protection	Class I
Glow wire test (°C)	850
Lamp energy label (class)	A++
Nominal input voltage	220...240
Nominal frequency (Hz)	50...60



ELUX Ltd. reserves the rights to further improve the listed luminaires.
All data listed is not binding as median calculation and measurement is used for output and energy consumption.

PHYSICAL DATA

Lamp included	Yes
Included lamp	Integrated LED
Nominal product height (mm)	65
Nominal product width (mm)	65
Nominal product length (mm)	675
Weight (kg)	3
Diffuser finish	Opal
Diffuser material	PMMA

PACKAGING

Single packaging type	Carton
Packaging outer length (cm)	68
Packaging outer width (cm)	7
Packaging outer height (cm)	7
Single package volume (dm3)	3,33
Single product gross weight (kg)	3.5
Single packaging weight (kg)	0.5

Photometry

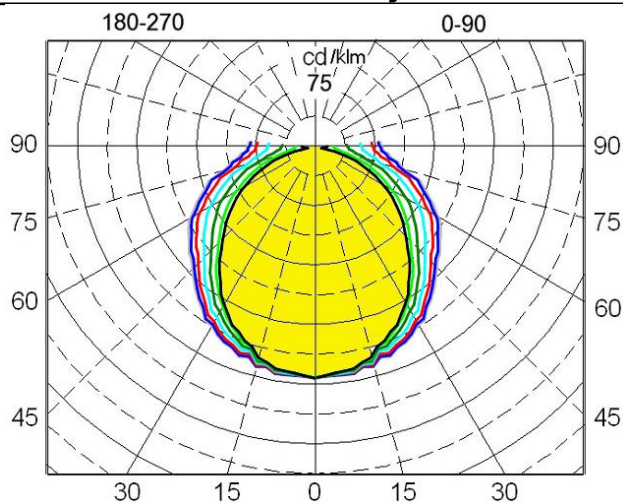

ELUX Ltd. reserves the rights to further improve the listed luminaires.
All data listed is not binding as median calculation and measurement is used for output and energy consumption.